

# CONTHERM *Scientific Limited*

TECHNICAL MEMORANDUM

PRODUCT :PRECISION

No : 0081

FROM : Contherm Scientific Ltd  
TO : ALL AGENTS

DATE : 9/5/2002

**SUBJECT: STEAM PUMP ASSEMBLY/CLEANING**

**Ensure ALL power is removed before commencing disassembly.**

The pump used to supply the water from the storage tank to the steam injector may become clogged, when this happens the pump must be disassembled for cleaning.

PUMP HOUSING (CONTAINS WATER FILTER)

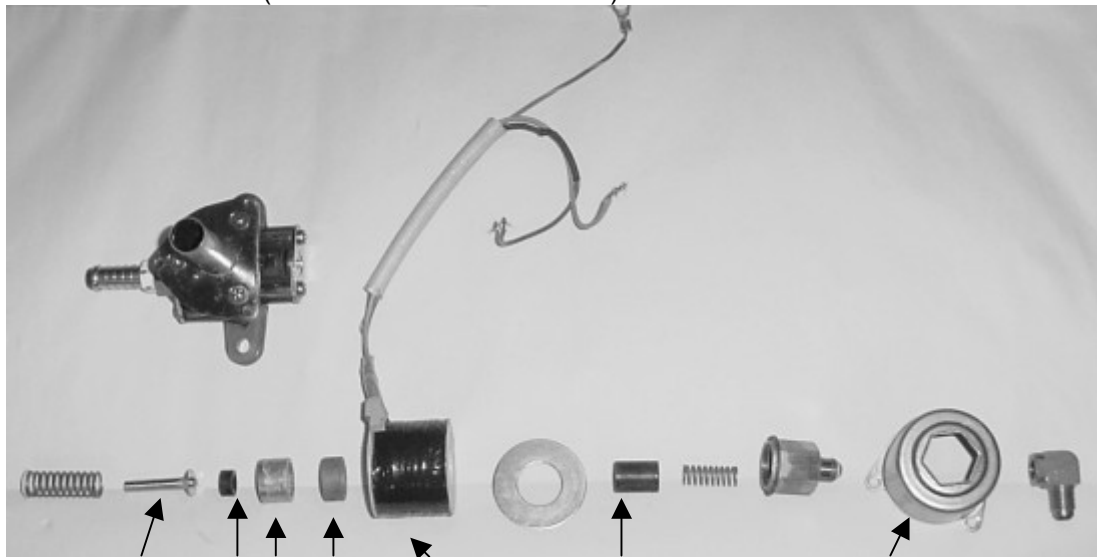

PISTON S4 S3 S2 COIL S1 COIL COVER

INLET HOSETAIL

WATER FILTER

PUMP BODY

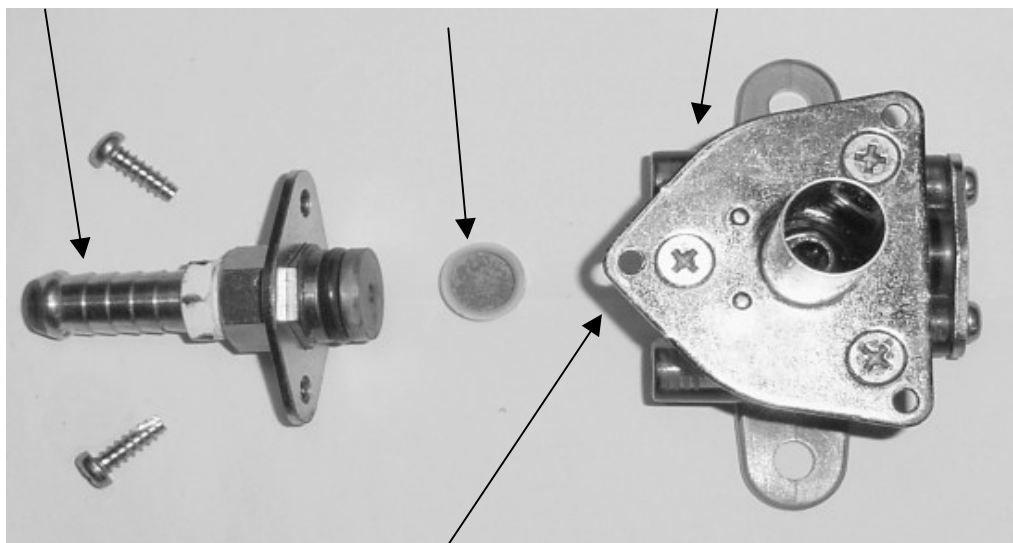

WHEN ASSEMBLED WATER FILTER GOES IN HERE

**Cleaning or Replacing the pump internal water filter.**

The most likely fault is that the pump water filter has become blocked. To clean or replace the filter: remove the two screws in the plate that holds the inlet hosetail to the pump body. Once released a gentle pull on the hosetail will release the unit from the pump body exposing the filter which is located inside the pump body behind the hosetail. Unbolt the pump from the mounting plate and tip the pump downwards knocking it gently into the palm of your hand, this will dislodge the filter. Clean or replace the filter and reassemble the pump again. Replace any plastic hoses that have become cloudy with debris. Prime the pump using DIAGNOSTIC No3. The pump may sound fairly noisy until it primes.

**To disassemble the pump:**

If the pump body has the three fixing screws (item (A) below), then remove these screws to gain access to the other pump parts. If the pump body DOES NOT have these screws you must loosen the pump body nut (item(B) below) to gain access.

DO NOT attempt to loosen the pump body nut if the pump has the three screws.

